

iPadOS Apps guide

See it Possible



Contents of the guide

- 01 User Profiles iOS
- 02 Education and AAC
- 03 Smart Home
- 04 Workplace
- 05 Entertainment
- 06 Social
- 07 Retail, online shopping

User Profiles

Early Stage User Profile 1

Goal: Communication and Learning

Activities: Use AAC, cause & effect games, apps with large cells.

This configuration seeks to limit the number of options the user must choose between, and avoid accidental clicks.

Hot Corners: None.

Custom Actions: Touch controls for the communication partner.

Single Tap: Always keep “Open Menu”

Double Tap: Toggle Pause/Resume Dwell

Long Press: Enable/Disable Fallback.

The communication partner should enable or disable the fallback as needed.

- Enable fallback, when a user is learning how to select actions from the AssistiveTouch Menu.
- Disable fallback, when it is desired to repeat an action (*ie. Hold and drag inside a drawing or swiping app*).

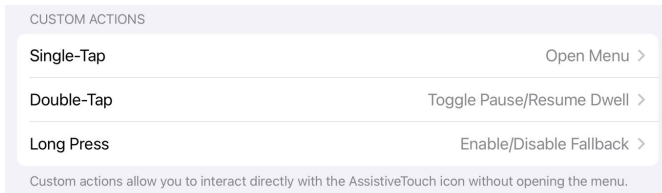

AssistiveTouch Menu: Begin with limited icons, and continue adding as the user builds eye gaze skills.

1. **Tap:** If desired, begin with only this option
2. **Pause/Resume Dwell**
3. **Long Press:** useful in some games.
4. **Hold and Drag:** useful for drawing apps or games.

Tips:

- Set the Fallback Action to “pause” to avoid accidental clicks.
- Use a Dwell time of .25-.75s to work with cause & effect.
- Use widgets to create bigger buttons for most commonly used apps.
- Deselect “always show menu” if tap is the only icon on the AssistiveTouch Menu.
- Calibrate with 1 or 5 points.
- Use Guided Access to restrict a user to a certain app and avoid unintentional activations.

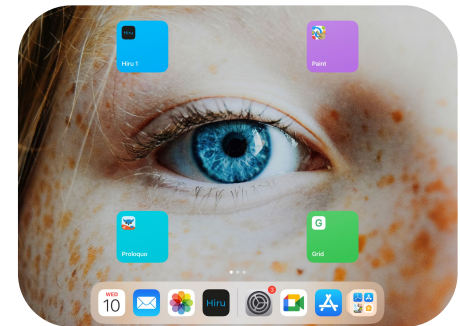

Early Stage User Profile 2: Context Dependent

Goal: Communication and Learning. Use this as a continuation of Profile 1.

Activities: Use AAC, cause and effect and games apps. This configuration seeks to shorten the journey to get to any icon so you can get there fast.

Hot Corners:

Top Left: Hold & Drag (common in games)

Top Right: Snap to Item (games often require this OFF)

Bottom Left: Pause/resume Dwell

Bottom Right: Create a [shortcut](#) to communication.

Tip: Use a [background photo](#) with instructions for each hot corner command.

Custom Actions: Controls for the communication partner.

Single Tap: Always keep “Open Menu”

Double Tap: Toggle Pause/Resume Dwell

Long Press: Enable/Disable Fallback

AssistiveTouch Menu:

- **Home:** jump to home screen
- **App Switcher:** change between apps
- **Tap**
- **Long Press**
- **Hold and Drag**
- **Custom:** create & use custom gestures (swipe, long press, etc.)
- **Pause/Resume Dwell**
- **Disable/Enable Fallback**

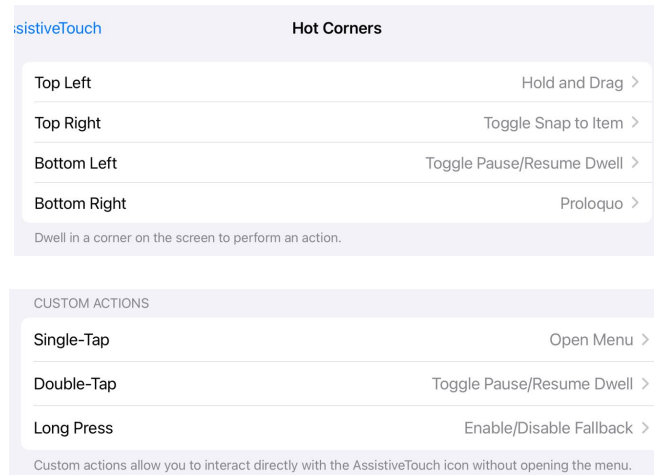

The screenshot shows the AssistiveTouch settings interface. At the top, it says 'AssistiveTouch' and 'Hot Corners'. Below this is a table with four rows: 'Top Left' (Hold and Drag), 'Top Right' (Toggle Snap to Item), 'Bottom Left' (Toggle Pause/Resume Dwell), and 'Bottom Right' (Proloquo). Below the table is a note: 'Dwell in a corner on the screen to perform an action.' Below that is a section for 'CUSTOM ACTIONS' with three rows: 'Single-Tap' (Open Menu), 'Double-Tap' (Toggle Pause/Resume Dwell), and 'Long Press' (Enable/Disable Fallback). At the bottom, it says 'Custom actions allow you to interact directly with the AssistiveTouch icon without opening the menu.'

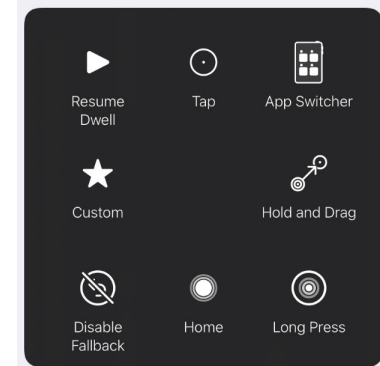

Independent User Profile

Goal: access and communication

Allow a user to access all features of the iPad in order to work, play, communicate and more.

This configuration seeks to maximize the number of icons available to the user, so they can perform the widest variety of actions possible.

Hot Corners:

Top Left	Toggle Pause/Resume Dwell >
Top Right	Enable/Disable Fallback >
Bottom Left	Toggle Auto-Hide >
Bottom Right	Toggle Snap to Item >

Dwell in a corner on the screen to perform an action.

**Note: in some cases it's easier to use only the left-side corners to avoid triggering other iPad actions (ie. Control Center).*

Hot Corner actions can be replaced with icons on the AssistiveTouch menu or Widgets.

AssistiveTouch Menu:

- **Home:** jump to home screen
- **App Switcher:** change between apps
- **Device:** iPad features (ex. volume, sleep, etc.)
- **Dwell Menu:** move menu and other features inside
- **Scroll Menu:** more scroll directions
- **Shortcut: Open Hiru App** shortcut for recalibration
- **Custom:** create & use custom gestures (swipe up, etc.)
- **Tap:** Single tap

Other Tips:

- Create shortcuts in the shortcuts app to add as Widgets, Hot Corners, or place on the AssistiveTouch Menu.
- Start with the Fallback action set to “pause” to avoid accidental clicks.
- Calibrate using 9 or 16 points for highest accuracy.

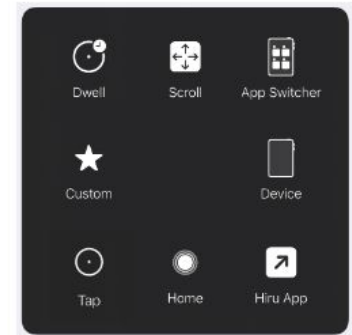

Create a Shortcut

It's possible to add a shortcut directly to the AssistiveTouch Menu or Hot Corner.

- ex. shortcut to Hiru App to access a calibration in one click.

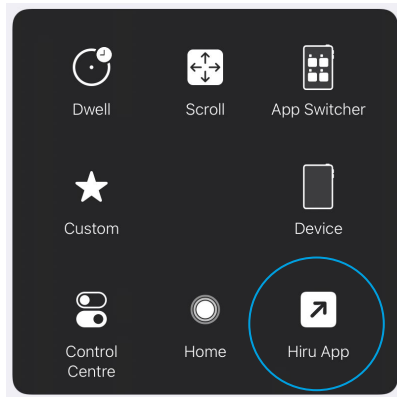

1. Open Apple's "Shortcuts" App
2. Click the + sign in the upper left corner.
3. Select the type of shortcut (Open App, set timer, etc.)
 - a. Choose from different options depending on apps downloaded and the shortcut goal.
 - b. Find the Apple instructions [HERE](#).
4. Name the Shortcut (Ex. Open Hiru App)
5. To add to the AssistiveTouch Menu, go to **iPad settings > Accessibility > Touch > AssistiveTouch > Customize top level menu** and a shortcut from the bottom of the list. They appear there automatically when created.

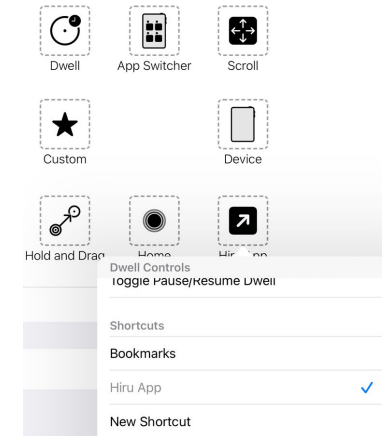



Education and AAC

Proloquo2go



Description:

Proloquo is a symbol based AAC app designed for non speaking children and adults learning language through AAC. Proloquo's unique design uses the latest research and data from over 10,000 AAC users.

Proloquo Coach equips families and educators with the tools and knowledge needed to support children and students in their journey of learning to communicate using AAC.

Settings:

Snap to Item: ON

AutoHide: OFF

*Add Snap to Item and AutoHide as a Hot Corner to easily toggle on and off.

Assistive touch menu:

- **Pause Dwell:** Pause the click functionality
- **Scroll:** To browse thru lists of symbols
- **Move Menu:** Move the AT Menu if it is covering a button you want to access.
- **Long Press:** To access more vocabulary options.
- **Home:** To leave the app and return Home

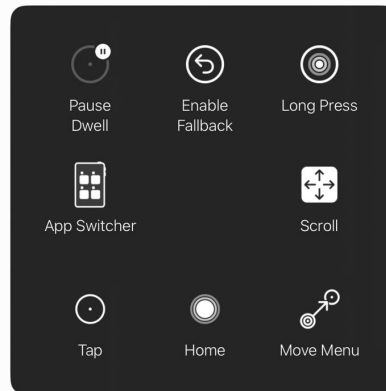

Proloquo



Description:

Proloquo is a symbol based AAC app designed for non speaking children and adults learning language through AAC. Proloquo's unique design uses the latest research and data from over 10,000 AAC users.

Proloquo Coach equips families and educators with the tools and knowledge needed to support children and students in their journey of learning to communicate using AAC.

Settings:

Snap to Item: ON

AutoHide: OFF

*Add Snap to Item and AutoHide as a Hot Corner to easily toggle on and off.

Assistive touch menu:

- **Pause Dwell:** Pause the click functionality
- **Move Menu:** Move the AT Menu if it is covering a button you want to access.
- **Home:** To leave the app and return Home

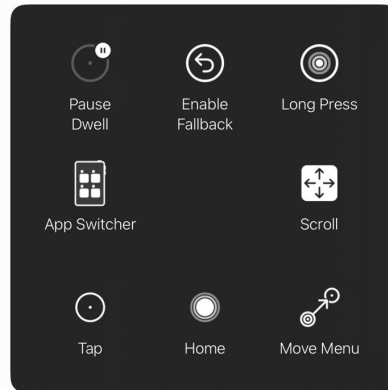

Predictable 6



Description:

Predictable is a text based app for AAC to give a voice to people who live with communication barriers. It can be accessed with many access methods including eyegaze via [integration](#) or Assistive Touch in the iPad.

Assistive touch menu:

- **Pause Dwell:** Pause the click functionality
- **Move Menu:** Move the AT Menu if it is covering a button you want to access.
- **Home:** To leave the app and return Home
- **Tap:** use to select items in touch mode.

Settings:

Snap to Item: ON

AutoHide: OFF

*Add Snap to Item and AutoHide as a Hot Corner to easily toggle on and off.

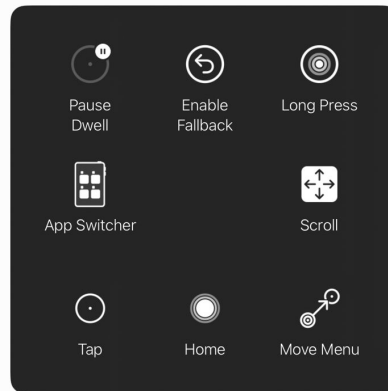

SimPODD



Description:

PODD is a powerful tool for communication. It is [a complete solution for AAC](#). It is used by people of all ages and with a wide variety of disabilities. It's especially powerful for people with emerging language skills.

AssistiveWare created simPODD to make your experience with PODD easier. simPODD is a complete and easy-to-use PODD app, wherever you are on your communication journey.

Settings:

Snap to Item: ON

AutoHide: OFF

*Add Snap to Item and AutoHide as a Hot Corner to easily toggle on and off.

Assistive touch menu:

The tap function is all you need but these options will server users well.

- **Pause Dwell:** Pause the click functionality
- **Scroll:** To browse through lists of symbols
- **Move Menu:** Ability to move the AT Menu
- **Home:** To leave the app and return Home

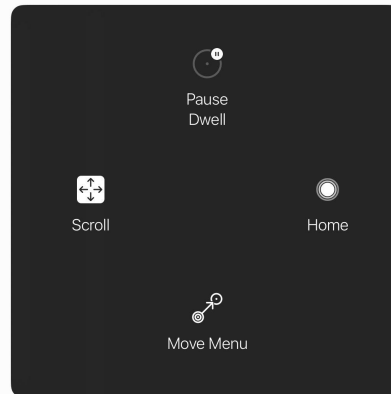

Grid for iPad



Description:

Grid for iPad is a complete AAC solution that includes instant access to resources for symbol and text communication. The app includes content for different ages, conditions and levels of literacy.

Edit Grids for Eye Gaze:

Pause: To add a Pause button inside a Gridset, copy a hidden “Rest” button in an existing Gridset (ex. Dilbert the Dog), and paste in the desired Gridset. Then delete the command “Show only when Access method is available”. This will freeze the cells in the gridset, without pausing AssistiveTouch.

AssistiveTouch Menu: To avoid having to move the AT menu around, create an empty cell in most used Gridsets where the AT menu can be placed.

AssistiveTouch Settings & Menu

- **Tap:** use this to open and navigate through the app.
- **Pause Dwell:** Pause the click functionality.
- **Move Menu:** Ability to move the AT Menu
- **Home:** To leave the app and return Home

Snap to Item: ON

AutoHide: ON

- Turn Autohide on for Cause & Effect games.
- Turn Autohide off for text based communication Gridsets.

*Add Snap to Item and AutoHide as a Hot Corner to easily toggle on and off.

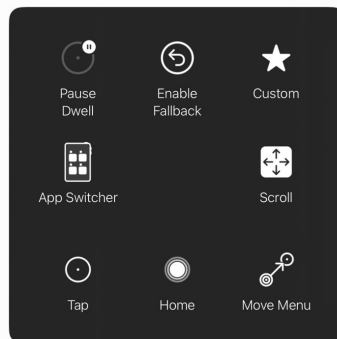

CoughDrop



Description:

CoughDrop is an Augmentative and Alternative Communication (AAC) software that can fill the gaps to make every voice heard.

CoughDrop is an app that helps bring out the voices of those with complex communication needs through technology that easily adapts to the individual and supports everyone around them trying to help them succeed.

Tips:

Make the AssistiveTouch Menu invisible to avoid blocking any cells on the pageset.

*Add "Open Menu" as a Hot Corner to access it.

Assistive touch menu:

- **Single Tap:** use this to open and navigate through the app.
- **Pause Dwell:** Pause the click functionality.

Add **Disable Fallback** as a **Hot Corner** for easy access if the user is independent. Or add it as a **Custom Action** to the AssistiveTouch Menu icon if they are not.

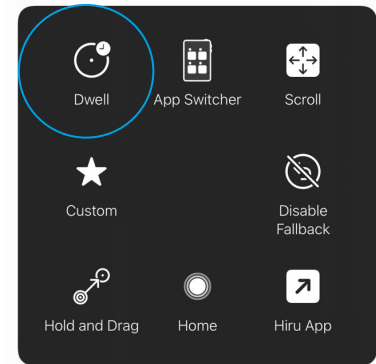

Go Talk Now



Description:

GoTalk NOW is an AAC app, with options to create adjustable page layouts, customizable navigation, recorded and text-to-speech capabilities, and an included symbol set for iPad. It can be accessed through touch and now eye gaze via AssistiveTouch.

Settings:

Snap to Item: ON

AutoHide: OFF

*Add Snap to Item and AutoHide as a Hot Corner to easily toggle on and off.

Assistive touch menu:

- **Pause Dwell:** Pause the click functionality
- **Scroll:** To browse thru lists of symbols
- **Move Menu:** Move the AT Menu if it is covering a button you want to access.
- **Custom:** Create a custom gesture for a 5 second long press to access the home menu.
- **Home:** To leave the app and return Home

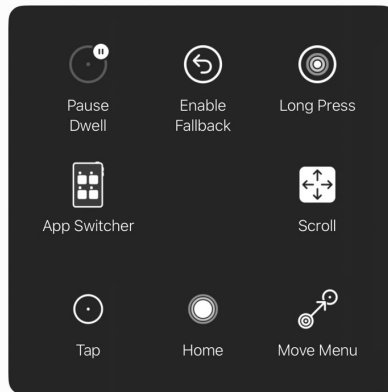

TouchChat HD (with WP)



Description:

TouchChat is a full-featured communication solution for individuals who have difficulty using their natural voice. TouchChat is designed for individuals with Autism, Down Syndrome, ALS, apraxia, stroke, or other conditions that affect a person's ability to use natural speech.

Tips:

Make the AssistiveTouch Menu invisible to avoid blocking any cells on the pageset.

*Add "Open Menu" as a Hot Corner to access it.

Assistive touch menu:

- **Pause Dwell:** Pause the click functionality
- **Scroll:** To browse thru lists of symbols
- **Move Menu:** Move the AT Menu if it is covering a button you want to access.
- **Long Press:** To access more vocabulary options.
- **Home:** To leave the app and return Home

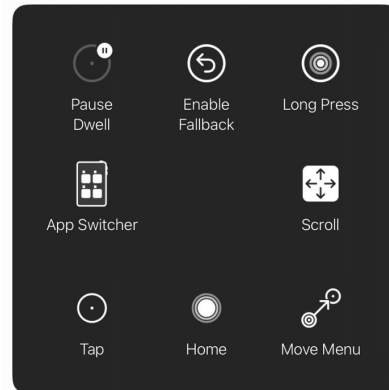

Settings:

Snap to Item: ON

AutoHide: OFF

*Add Snap to Item and AutoHide as a Hot Corner to easily toggle on and off.

HelpKidzLearn: Finger Paint

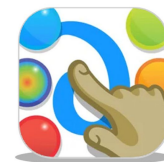

Description:

An opportunity to finger paint without the mess! Explore with color and fun sound effects, music, or no sound at all. Finger Paint with Sounds offers a fun alternative to help learners to practice their first interactions with a eye gaze or touch.

More information:

This is a free app available for download at the App Store.

Assistive touch menu:

- **Single Tap:** use this to open and navigate through the app.
- **Hold and Drag:** click and drag to paint. Pass through a color using this action and it will follow your gaze.
- **Disable Fallback:** Use this to maintain the “hold and drag” while playing.
- **Pause Dwell:** Pause the click functionality.
- Disable **Hot Corners**

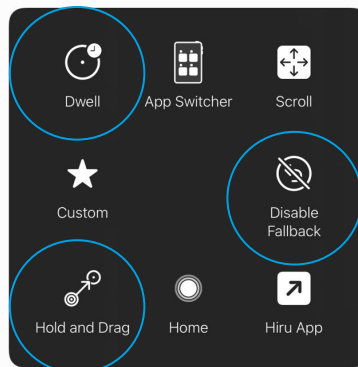

Toca Kitchen Monsters



Description:

In Toca Kitchen Monsters you can cook and play with food for two hungry monsters. Pick any ingredient and prepare it in your own way! Slice, boil, fry, cook, microwave or mix? And wait for the response from the hungry monster.

The app is toy where you and your kids get to explore cooking. What happens if you mix a carrot and then fry it? What do Monsters like to eat? Why do the Monsters spit some food out if it is over-seasoned? Toca Kitchen supports free play for all ages and is a great way to use your imagination.

More information:

Add **Pause Dwell**, **Disable Fallback**, and **Tap** as **Hot Corners** for easy access if the user is independent.

Assistive touch menu:

- **Single Tap:** use this to open, navigate through the app, and choose different foods and actions.
- **Hold and Drag:** use this to add salt and pepper and feed the monster.
- **Scroll Right or Left:** use these to open side menus (the fridge or cabinet). Another option in addition to hold & drag.
- **Disable Fallback:** Use this to maintain the “hold and drag” while playing. First click, Disable fallback, then Hold and Drag.
- **Pause Dwell:** Pause the click functionality.

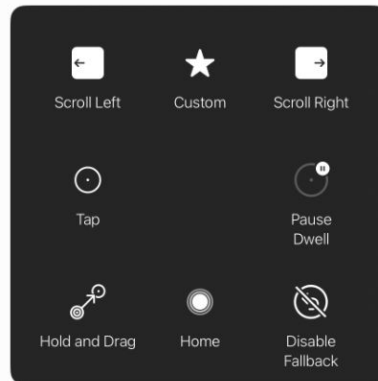

HelpKidzLearn: Sensory Room



Description:

Look at the pictures and talk about the story in your own words in this fun cause and effect activity. What can you see in the multi-sensory room? Do you like the bubble tube or disco lights best? Look at the screen to see what happens next.

More information:

This is a free app available for download at the App Store.

Assistive touch menu:

- **Single Tap:** use this to open and navigate through the app. This is the default action.
- **Pause Dwell:** Pause the click functionality.

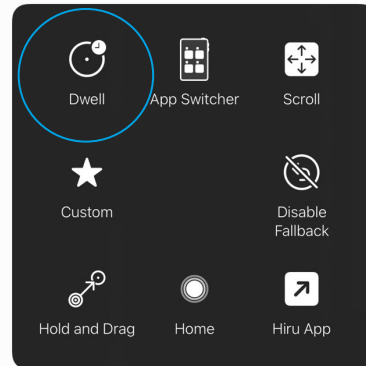

HelpKidzLearn: Choose it Maker



Description:

Download and play personalised activities offline. These may include cause and effect activities, assessment activities, reading and literacy activities, sound lotto and matching games, multiple choice questions, quizzes, communication aids and more!

More information:

This is a free app available for download at the App Store.

Assistive touch menu:

- **Single Tap:** use this to open and navigate through the app. This is the default action.
- **Pause Dwell:** Pause the click functionality.

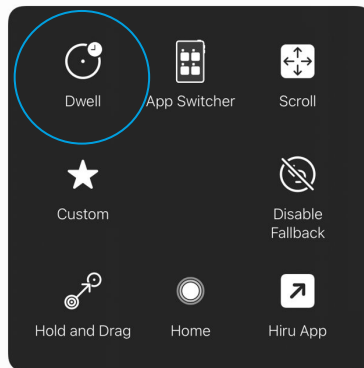

Help Kidz Learn: World Cup Soccer



Description:

This accessible and inclusive game has been designed to encourage and develop hand-eye coordination and switch timing skills. Auditory prompts and a clear background with bright objects make this an ideal game for children with visual and perceptual difficulties.

It can be used with eyegaze instead of switch control or combined with a bluetooth switch like the NeuroNode.

More information:

Creator: HelpKidzLearn.

Use an AssistiveTouch Menu with few options for early stage users.

Assistive touch menu:

- **Single Tap:** use this to open and navigate through the app.
- **Pause Dwell:** Pause the click functionality.
- **Yes or No Shortcut:** takes you directly to the app.
- **Home:** Direct Access to home screen.

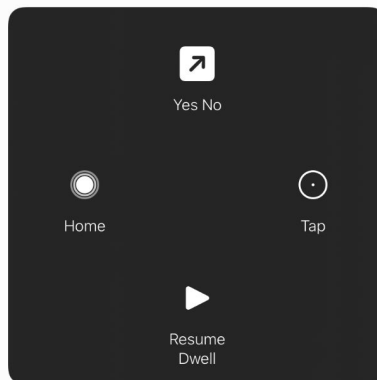

Yes or No Communication



Description:

Yes or No is a rudimentary digital communication aid. Yes and No can be used as a first step in establishing communication before a user moves on to more sophisticated AAC apps.

More information:

Creator: Rudimentary AAC.

Use an AssistiveTouch Menu with few options as this is a very early stage app.

Assistive touch menu:

- **Single Tap:** use this to open and navigate through the app.
- **Pause Dwell:** Pause the click functionality.
- **Yes or No Shortcut:** takes you directly to the app.
- **Home:** Direct Access to home screen.

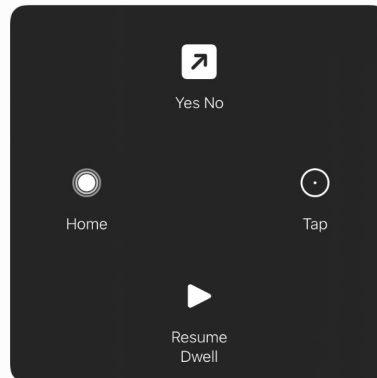

Verbal Me



Description:

Verbal Me is an easy to use AAC and choice board app for non-verbal students. Use default choice boards or create your own.

Assistive touch menu:

- **Single Tap:** use this to open and navigate through the app.
- **Pause Dwell:** Pause the click functionality.
- **Verbal Me Shortcut:** takes you directly to the app.
- **Home:** Direct Access to home screen.

More information:

Cost: \$6.99

Use an AssistiveTouch Menu with few options for very early stage users.

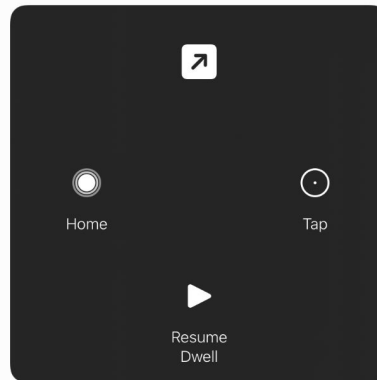

Swift playgrounds



Description:

Swift Playgrounds is a revolutionary app for iPad that offers a fun way to learn and experiment with Swift, a powerful programming language created by Apple and used by professionals to develop popular apps.

Assistive touch menu:

- **Single Tap**: use this to open and navigate through the app
- **Scroll**: Scroll the page when needed
- Disable **Hot Corners**

More information:

Use the keyboard, so you need good accuracy. The video is related to the application **Get Started with Code**, but you can have others.

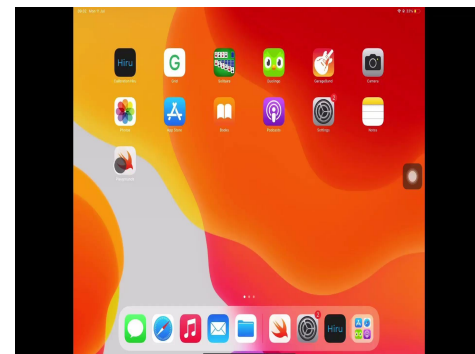
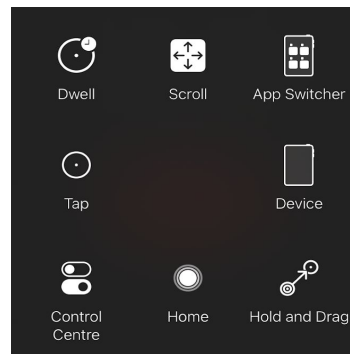

Duolingo



Description:

Duolingo gives the opportunity to learn more than 35 languages through quick, bite-sized lessons. Practice speaking, reading, listening, and writing to build your vocabulary and grammar skills.

Assistive touch menu:

- **Single Tap:** Use this to open and navigate through the app
- **Scroll:** This allows you to access more levels

More information:

There is a demo trial but after you have to create an account.

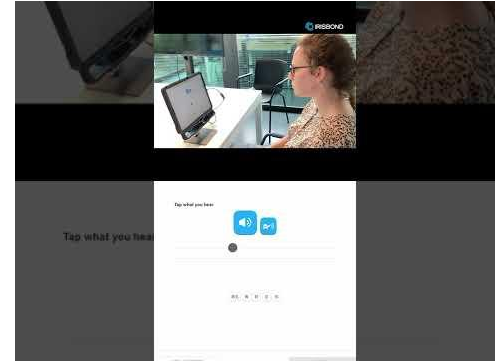
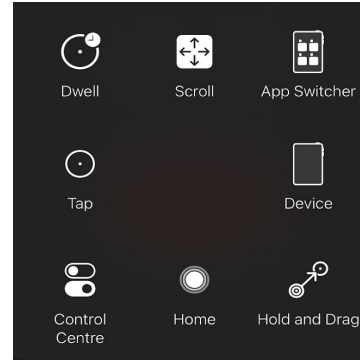

Description:

Get personalized recommendations that match your unique interests, or browse TED's library of thousands of inspiring, informative, transformational videos

Assistive touch menu:

- **Single Tap:** Use this to open and navigate through the app
- **Scroll:** This allows you to access more videos that are not in the first page
- **Device:** Use this to control the volume of the videos

More information:

You can change your preferences every time you want

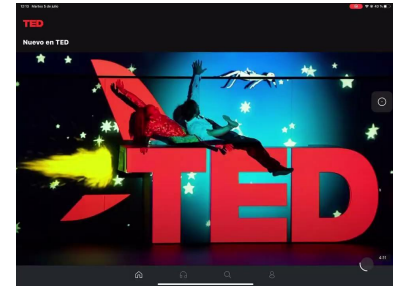
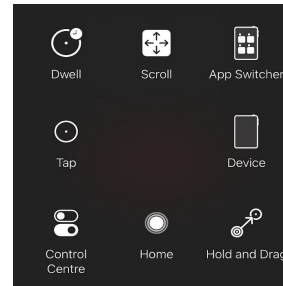

My Story School Bookmaker



Description:

My Story is a great way to engage your K-5 students through storytelling. The app is used to promote literacy, comprehension, creative thinking, and self-driven learning by creating and sharing e-books and adding drawings, photos, recordings and stickers.

More information:

Add **Pause Dwell** and **Disable Fallback** as **Hot Corners** for easy access if the user is independent. Or add these as a **Custom Action** to the AssistiveTouch Menu icon if they are not.

Assistive touch menu:

- **Single Tap:** use this to open and navigate through the app.
- **Hold and Drag:** click and drag to draw or resize pictures.
- **Disable Fallback:** Use this to maintain the “hold and drag” while playing. First click, Disable fallback, then Hold and Drag.
- **Pause Dwell:** Pause the click functionality.

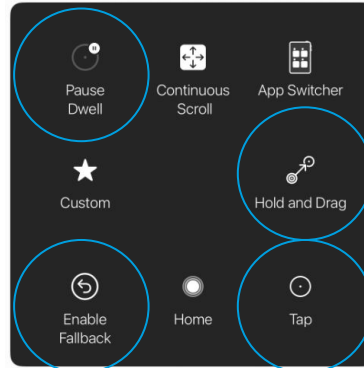



Smart Home

HomeKit



Description:

Connect and control smart home devices all from one single app.

Automation and shortcuts are made possible through this app.

Assistive touch menu:

- **Single Tap:** use this to open and navigate through the app
- **Long Press:** This allows you to access more commands within each Device (e.g. Change the color of a lamp)
- **Control Center:** Access the Homekit directly from the control center

More information:

Some set up of smart home accessories will require assistance.

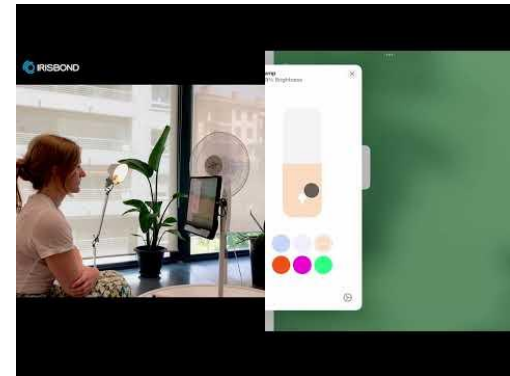
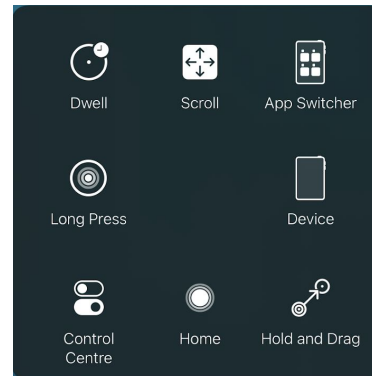



Workplace

Apple pages



Description:

Pages is a powerful word processor with everything you need to create documents so spectacular that they are easy on the eyes

Assistive touch menu:

- **Single Tap:** use this to open and navigate through the app
- **Hold and drag:** This allows you to move the object you have added through the page
- **Scroll:** Scroll the page when needed

More information:

With real-time collaboration features, you and your team can work together at the same time

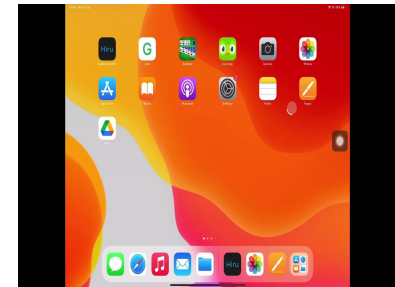
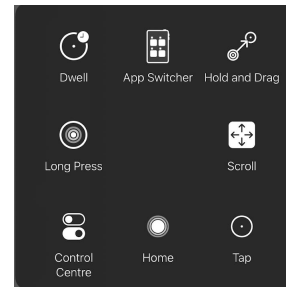

Drive - Google Docs



Description:

Google Drive is a place where you can back up your files and access them on any device. It's easy to invite others to view, edit or comment on your files or folders.

Create, edit and collaborate on documents on the go with the **Google Documents** application. Work with other users in real time and share documents with your team.

More information:

You have to have a Google account to access both applications.

Needs accuracy, not very easy to use at first.

Assistive touch menu:

- **Single Tap:** use this to open and navigate through the app
- **Scroll:** Scroll the page when needed

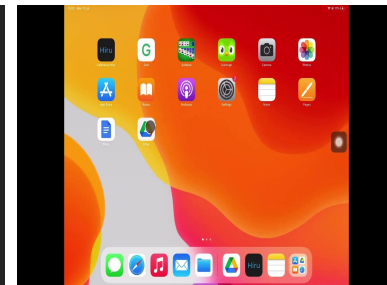
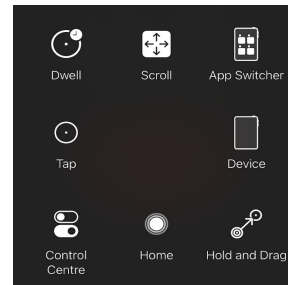



Entertainment

Description:

Apple TV is a streaming service where you can find Apple Originals content, including award-winning series, great movies, groundbreaking documentaries, children's shows, comedies and more. And the best part is that the catalog expands every month.

You can use Apple TV remote or screen sharing from the Apple TV app.

More information:

For the remote, you need to add the apple TV icon to the control center of the iPad.

Assistive touch menu:

- **Single Tap:** Use this to open and navigate through the app
- **Scroll:** This allows you to access more series/movies
- **Control Center:** Access to the remote control of the TV from the control panel

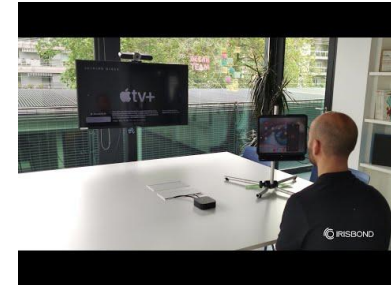
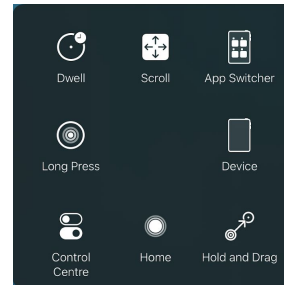

Fruit Ninja



Description:

Slice fruit, don't slice bombs – that's all you need to know to get started with addictive Fruit Ninja action!

The free version of the game has features to play and practice important eyegaze skills such as hold and drag and pause.

Different modes are available from playing in Arcade mode, to practicing in Zen mode.

More information:

Add **Pause Dwell** and **Disable Fallback** as **Hot Corners** for easy access if the user is independent. Or add these as a **Custom Action** to the AssistiveTouch Menu icon if they are not.

Assistive touch menu:

- **Single Tap:** use this to open and navigate through the app.
- **Hold and Drag:** With this activated, gaze at the fruit as it appears to slash them for points.
- **Disable Fallback:** Use this to maintain the “hold and drag” while playing. First click, Disable fallback, then Hold and Drag.
- **Pause Dwell:** Pause the click functionality. Use this if ads or videos appear.

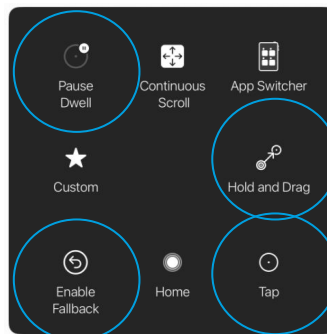

LaunchPad



Description:

Launchpad is the original number-one app for making and remixing electronic music. Instantly combine beats, basslines, melodies, vocals and FX loops into new creations. Layer DJ-style effects to chop and change your sound. Record your performance and share it with others.

More information:

This fun app gives you the chance to make music with your eyes.

Assistive touch menu:

- **Single Tap:** use this to open and navigate through the app. Choose your cards just by clicking.
- **Custom Gesture:** Swipe up & Swipe down. Use these gestures to increase or decrease filters for the sounds

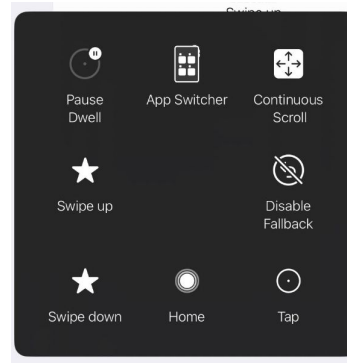

Description:

Take the classic card game from the kitchen table to anywhere! Now with new rules, new worldwide tournaments, game modes, and much more.

Assistive touch menu:

- **Single Tap:** use this to open and navigate through the app. Choose your cards just by clicking.

More information:

You can connect more than one devices so that you can play the same match together.

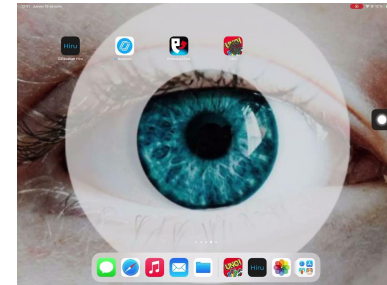
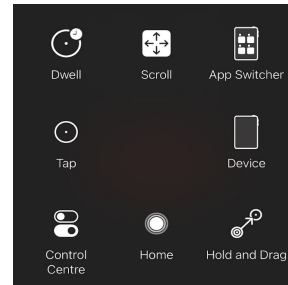

Pet Rescue Saga



Description:

This free app from the makers of Candy Crush Saga offers you to improve puzzle skills in a fun and cute way.

Match two or more blocks of the same colors with your eye-gaze and save the pets!

Assistive touch menu:

- **Single Tap:** use this to open and navigate through the app. Select two or more dice of the same color next to each other with a Single Tap. They will disappear and you can continue connecting other dice and move to the next level.

More information:

Add **Pause Dwell** as **Hot Corner** for easy access if the user is independent.

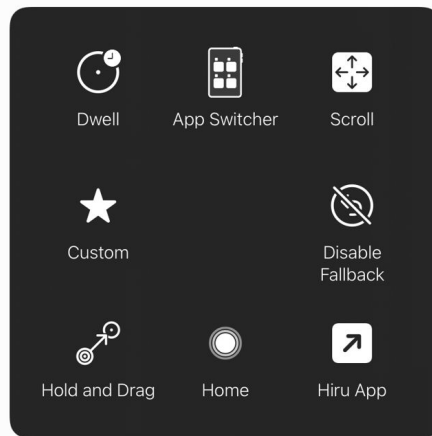

Bejeweled



Description:

A series of tile-matching puzzle video games for iPad. There are free or pay versions available.

More information:

Add **Pause Dwell** and **Disable Fallback** as **Hot Corners** for easy access if the user is independent. Or add these as a **Custom Action** to the AssistiveTouch Menu icon if they are not.

Assistive touch menu:

- **Single Tap:** use this to open and navigate through the app. Choose jewels to change by clicking on one, then clicking in the place where you want it to go.

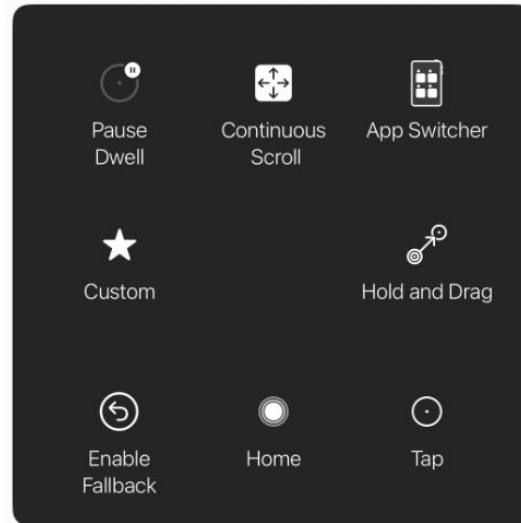



Social

Facetime



Description:

Get in touch with family and friends around the world with FaceTime audio and video calling

Assistive touch menu:

- **Single Tap:** Use this to open and navigate through the app
- **Device:** Use this to control the volume of the video calls

More information:

Remember to add the contact you want to call in your iPad's "Contacts" app first!

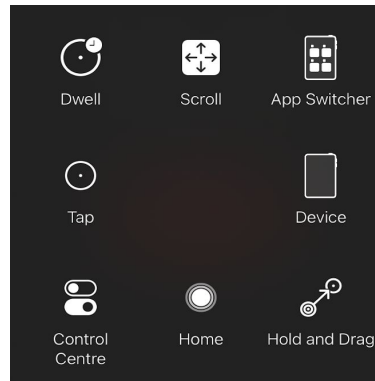

Instagram



Description:

Connect with friends, share what you are doing or see what's happening with people around the world.

Assistive touch menu:

- **Single Tap:** use this to open and navigate through the app
- **Scroll:** This allows you to access more photos and videos
- **Pause dwell:** This allows you to watch videos

More information:

You need to create an account

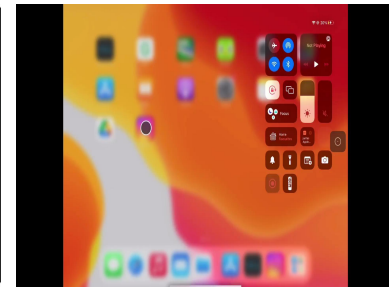
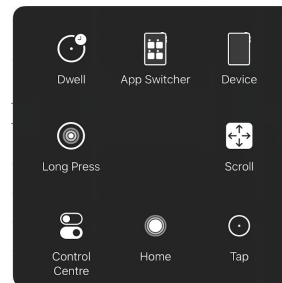



Retail, online
shopping

Description:

Latest trends in clothing for women, men & kids at ZARA online. Find new arrivals, fashion catalogs, collections & lookbooks every week.

More information:

If you are part of the community you can have some discounts.

Assistive touch menu:

- **Single Tap:** Use this to open and navigate through the app
- **Scroll:** This allows you to access more clothes that are not in the first sight

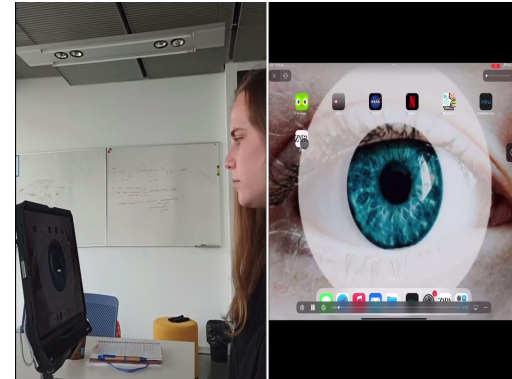
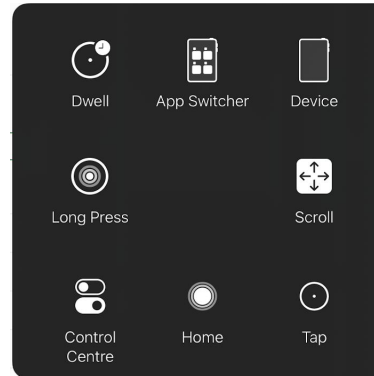

Do you have any questions?
Happy to answer!



Avenida de Tolosa, 75. Planta 2
Donostia San-Sebastián. 20018 Gipuzkoa
España +34 943 49 66 22

info@irisbond.com
www.irisbond.com

[See it Possible](#)